

UNPACKING THE VACMOBILE 20/2 MACHINE

The 20/2 machine is usually delivered on a small plywood pallet. There may be 1 or 2 cartons on the pallet. If there are 2 cartons on the same pallet, the larger carton will contain the 20/2 machine. The smaller carton will contain additional items supplied with the machine. If the package is opened in the following sequence, unpacking will be simple and the main package for the 20/2 will be reusable.

STEP 1

Remove the outer film.



STEP 2

Remove the smaller package (if any).

To certain destinations, the main package may have a metal shield around one corner of the main pack.



STEP 3

Cut all straps holding the 20/2 package and remove the metal impact shield (if any).

DO NOT OPEN THE TOP FLAPS OF THE CARTON.



STEP 4

Lift the complete carton off the plywood pallet to expose the machine and the foam packing blocks.



STEP 5

Cut the nylon ties securing the machine to the plywood base.



STEP 6

Lift the machine off the plywood base. Leave the castor brakes locked until the machine is on the floor – to avoid nipping your fingers.



STEP 7

Find the bag containing detailed instructions and the 3 spare catchpots for the resin trap. Each catchpot will contain a bottle of oil.

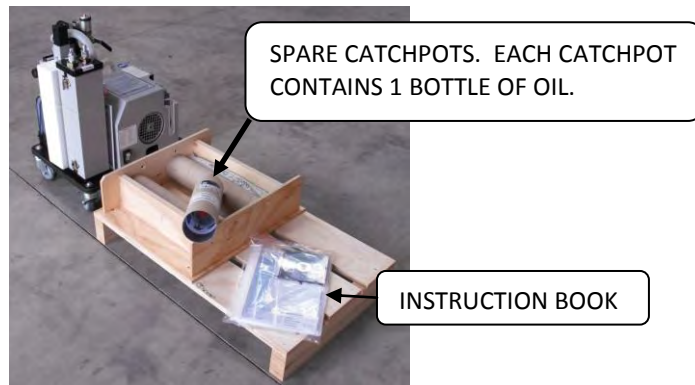

STEP 8

FILL THE VACUUM PUMP WITH OIL BEFORE START-UP!

Approximately 1 bottle of oil will be required. Do not over-fill.



ADD OIL BEFORE START-UP!
FILL TO BETWEEN
 $\frac{1}{2}$ & $\frac{3}{4}$ FULL

C:\VABS\Art, Logos, labels & leaflets current\Instructions 2010 VC10293A unpacking 20-2 machine.doc